

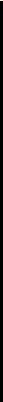

ARCHAEOLOGY AND MUSEUMS

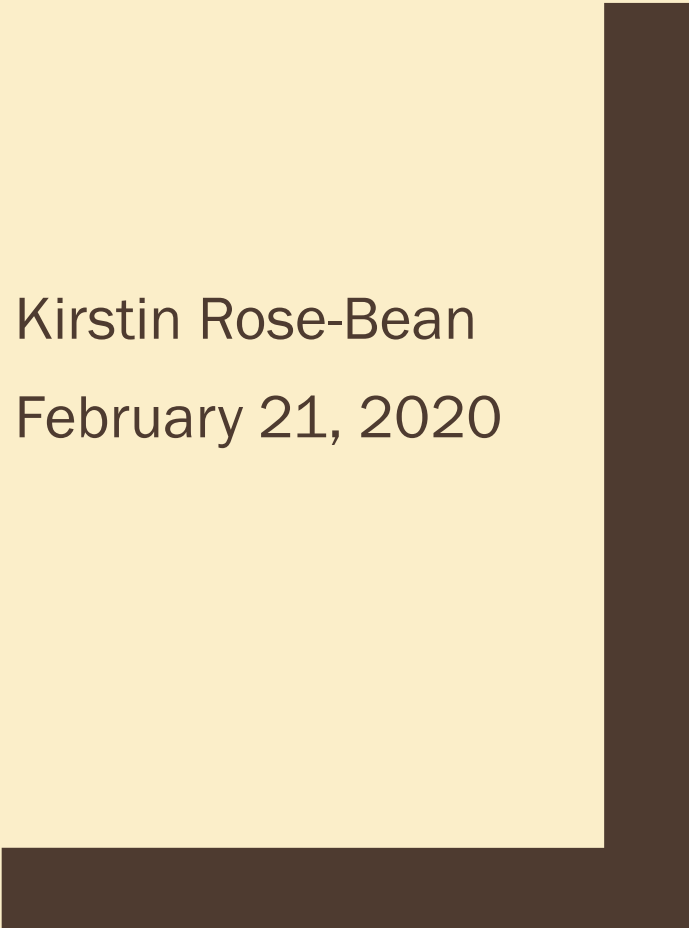

Kirstin Rose-Bean
February 21, 2020



Albright Artifact Collection Inventory Project



Archaeologists in Museums: A Collaborative Model



Overall Albright Institute Layout

N →

Hostel (H)

Kershaw Garden (KG)



Director's House (DH)

Balcony Apartment (BA)

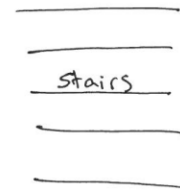

Lower Gardens, Parking lots, etc.

*Not to scale

The W.F. Albright Institute for Archaeological Research, Jerusalem

- "We are an American non-profit research center located in Jerusalem, dedicated since 1900 to the study of the ancient Near East."



Albright Institute of Archaeological Research (AIAR) Artifact Inventory Project Goals

“This summer Kirstin Rose-Bean will be working on helping the Albright inventory the many objects of historical significance that are housed at the Institute. A wide range of objects will be included in this inventory, including artifacts from Albright excavations, ~~items from the history of the AIAR (like the original telephone switchboard), the personal effects of W. F. Albright, and anything else that we find.~~ Kirstin will primarily focus on creating a list with a brief description of these objects and their current locations, marking each with a semi-permanent number for easier reference in the future. If there is time during her five-week stay, she may begin to gather documentation on provenance (potentially re-associating some artifacts with their excavation records) and legal title for the objects and may re-house objects in need of better preservation. Upon her return home, Kirstin will be presenting the results of her work to the faculty of the Museum Studies MA program at Baylor University as a thesis equivalent for her program.”





OBJECTS BELONGING TO THE AIAR

“Partage” gave excavators the right to keep some artifacts from each excavation for study or museum collections

Objects on Loan

- Excavations conducted on behalf of the Israel Antiquities Authority
- Near East Jerusalem in 1970
- Carl Graessner, Jr. and James F. Strange



Miscellaneous objects

Objects from Excavations



Small Objects



Archaeologists in Museums: A Collaborative Model



Literature Review: Collaborations between archaeologists and museums



Case studies:

*The Gault Site and the Bell County Museum
The University of West Florida Historic Trust*



A Simpler Model

Literature Review

Trends

- Archaeological artifacts in museum collections
- Museums and excavations on the same site
- Archaeological programming

Issues

- Almost all large-scale programs and exhibits
- Usually developed after excavation is complete
- Are not easily updated

Case Study 1: The Gault Site

- Exhibit at the Bell County Museum
- Tours advertised by both Bell County Museum and Williamson Museum

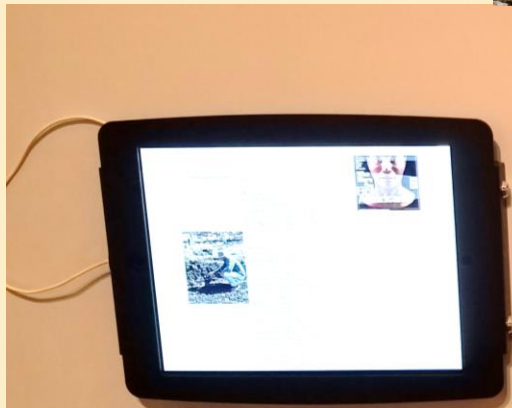

Texas Digs!

Texas is a rich source of archaeological knowledge. All around you is evidence of life and events of the past. Log onto TexasBeyondHistory.net to learn about history and archaeology in Texas. You could also get involved by joining the Texas Archeological Society and the Gault School of Archaeological Research where you can both learn about the past and even take part in excavations! Who knows, your contribution could be the next big find!

DIGGING AT GAULT

What's Happening There Today?

A BIG Focus On Clovis And Pre-Clovis Evidence

Archaeological efforts led by Dr. Michael Collins of the University of Texas at Austin are changing the way we understand how people lived here. It is no longer believed that the people who utilized Clovis technology were exclusively big-game hunters, but instead, that they were skilled foragers that used the Gault Site as a base camp, hunting and gathering in the surrounding ecotones.

New evidence has led researchers to believe that this culture was not the earliest in the hemisphere but followed an even earlier pioneering culture. This is a major "paradigm shift," since it was previously believed that Clovis represented the first peoples in the Americas.



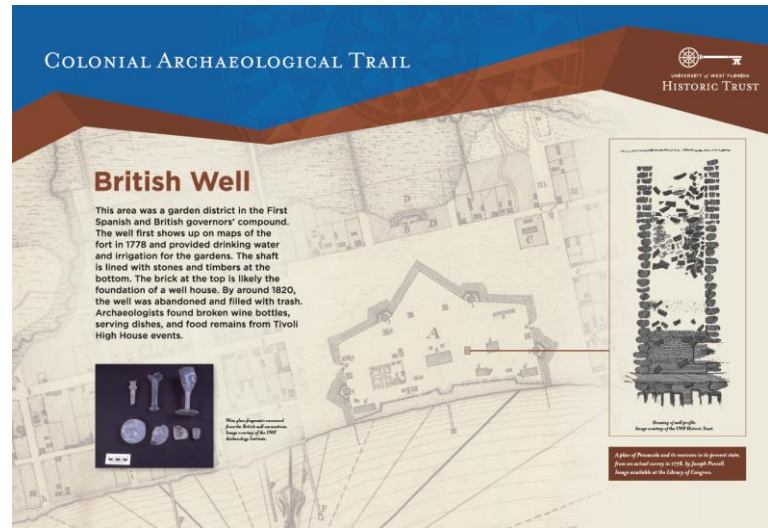

Case Study 2: UWF Historic Trust

- Arcadia Mill Archaeological Site
 - *Field School*
 - *Exhibit Space Run by Archaeologists*
- Colonial Archaeological Trail Improvements Project

A Simple Collaborative Model

The Model

- One case with some explanatory text panels
- The text panels are permanent
- The case updates every other year
- Can include objects from excavation, photos, archaeological tools, etc.



The Benefits

Creates a long-term relationship between the museum and excavation staff

Smaller commitment of time and finances

Content is always fresh

Tell a new story each update

Can supplement with programs

Selected Bibliography

- Albright, William F. *The Excavation of Tell Beit Mirsim. II, the Bronze Age*. The Annual of the American Schools of Oriental Research. New Haven: American Schools of Oriental Research, 1938.
- Bull, Robert J., and G. Ernest Wright. "Newly Discovered Temples on Mt. Gerizim in Jordan." *The Harvard Theological Review*, no. 2 (1965): 234–37.
- Bull, Robert J. "A Preliminary Excavation of an Hadrianic Temple at Tell Er Ras on Mount Gerizim." *American Journal of Archaeology*, no. 4 (1967): 387–93.
- Bull, Robert J. "The Excavation of Tell Er-Ras on Mt. Gerizim." *The Biblical Archaeologist*, no. 2 (1968): 58–72.
- Graessner, Jr., C. "Notes and News: Ras El-Jami', 'Isawiye." *Israel Exploration Journal*, no. 1–2 (1970): 120.
- Jackman, Carolyn J. "Archaeology of Bank One Ballpark, Phoenix, Arizona." *CRM* 23, no. 10 (2000): 40–44.
- Kerrigan, Ian. "Exhibiting 9/11: Interpreting Archaeology and Memory at the World Trade Center Site." *Exhibitionist* 30, no. 2 (2011): 20–24.
- Moore, J. Steven. "Archaeology Education at Fort Frederica." *CRM* 24, no. 2 (2001): 9–10.
- Overman, J. Andrew, Michael S Kreher, and Erin E Gibbs. "Archaeology, Conservation, and Public Engagement at Omrit: A Case Study." *Journal of Eastern Mediterranean Archaeology and Heritage Studies* 6, no. 4 (2018): 330–56.
- Pearson, Paul. "Greater Than Its Parts: Exhibition Collaborations for Small Museums." *Exhibitionist* 31, no. 1 (2012): 8–13.
- Petrie, Flinders. *Ancient Gaza IV: Tel El Ajjul*. ERA 56. London: British School of Archaeology in Egypt, 1934, Gaza Registrar of Graves 1701-1971, Plate LXVIII. (2019.AAC.0010).
- Rahmani, L. Y. *A Catalogue of Jewish Ossuaries: In the Collections of the State of Israel*. Jerusalem: Israel Antiquities Authority: Israel Academy of Sciences and Humanities, 1994.
- Strange, James F. "Late Hellenistic and Herodian Ossuary Tombs at French Hill, Jerusalem." *Bulletin of the American Schools of Oriental Research*, no. 219 (1975): 39–67.
- University of West Florida Historic Trust. "Arcadia Mill Archaeological Site." Historic Pensacola. Accessed October 20, 2019. <http://www.historicpensacola.org/explore-arcadia-mill/hours-tickets/arcadia-mill-archaeological-site/>.
- ———. "Colonial Archaeological Trail." Historic Pensacola. Accessed October 24, 2019. <http://www.historicpensacola.org/plan-your-visit/museums-properties/colonial-archaeological-trail/>.

Acknowledgments

- Thanks to Interviewees: Nancy Velchoff, Clark Wernecke, and Thomas Williams (GSAR), Stephanie Turnham and Coleman Hampton (Bell County Museum), and Adrienne Walker (UWF Historic Trust)
- Thanks to Dr. Julie Holcomb (Baylor), Dr. Matthew J. Adams, and Dr. Aaron Greener (AIAR)
- Thanks to my family, friends, and fur babies

